

LOCATION MAP SCALE 1:1000

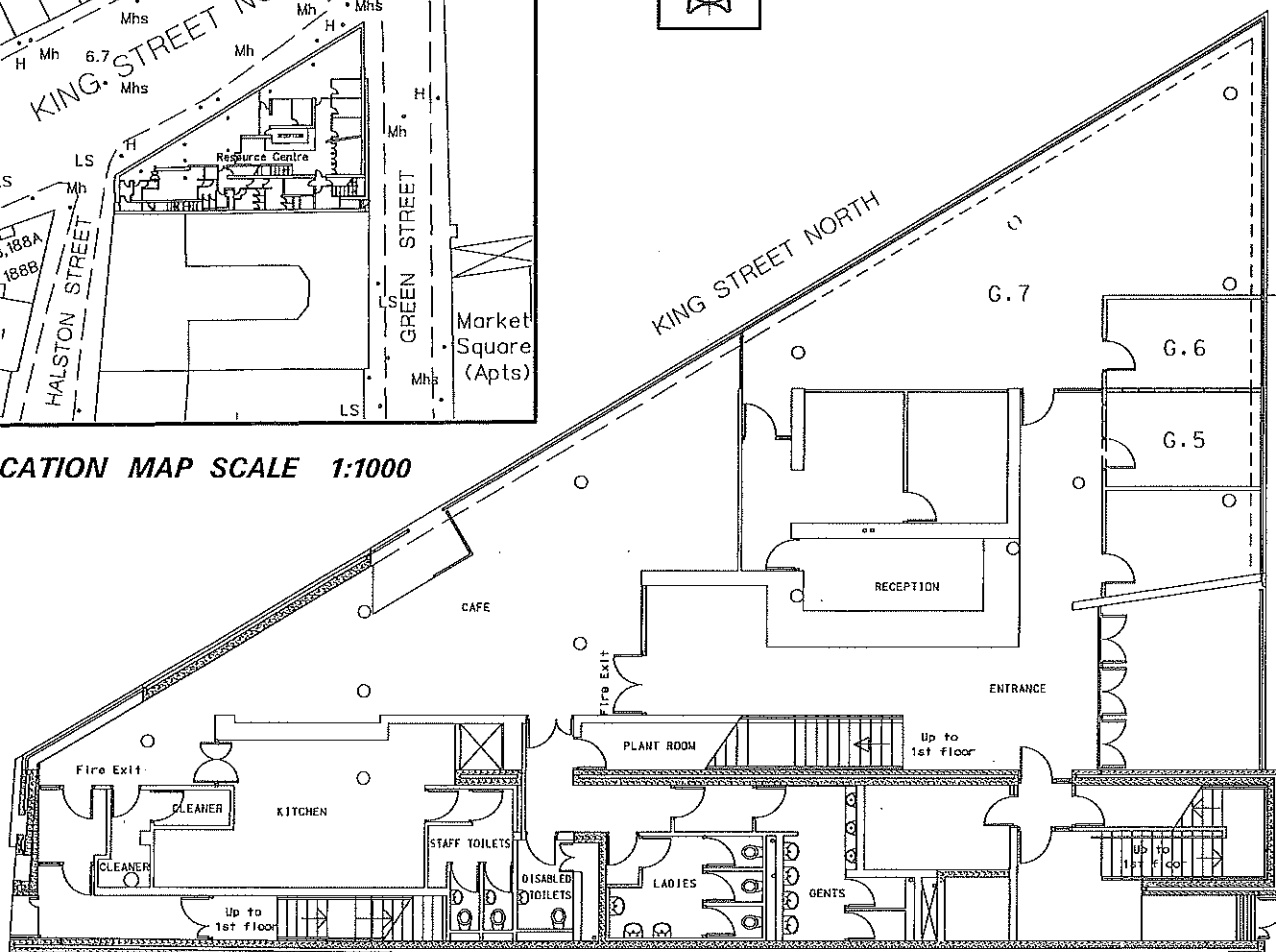

GROUND FLOOR PLAN (SCALE 1:200)

# HALSTON STREET /NORTH KING STREET /GREEN STREET - MACRO BUILDING

Rooms G.5, G.6, G.7 (AREA: 97.2 sq m)

Dublin City Council to North Dublin Citizens Information Service CLG

GRANT OF LICENCE



## DUBLIN CITY COUNCIL

Comhairle Cathrach Bhaile Átha Cliath  
 ENVIRONMENT AND ENGINEERING DEPARTMENT  
 An Roinn Comhshaoil agus Innealtóireachta  
 SURVEY AND MAPPING SERVICES DIVISION  
 Rannán Seirbhísi Suirbhéireachta agus Léarscailithe

O.S REF  
 3263-04, 3263-05

SCALE  
 1:1000 / 1:200

DATE 12.08.2010  
 Rev 15-2-2013

SURVEYED/  
 PRODUCED BY  
 TJC and FC

INDEX No FOLDER No CODE DWG No REV  
 FILE NO SM-2010-0367-0204- C3 - 001 - A.dgn

FOR PROPERTY REGISTRATION AUTHORITY PURPOSES ONLY  
 THIS MAP IS CERTIFIED TO BE COMPUTER GENERATED BY  
 DUBLIN CITY COUNCIL FROM ORDNANCE SURVEY DIGITAL MAPBASE

MICHAEL PHILLIPS  
 CITY ENGINEER

SIGNED PATRICK SHINE  
 MANAGER LAND SURVEYING & MAPPING  
 DUBLIN CITY COUNCIL

INDEX No.

SM-2010-0367-001